



Cistermiser

1. Instructions on how to install the Easyflush^{EVO} inlet valve

Based on the incoming water pressure, insert the correct restrictor into the bottom of the inlet valve according to the guidance below.

- 1 Place inlet valve through inlet hole with rubber washer inside the cistern.
- 2 Ensure the restrictor part is correct for the incoming water pressure, see details in **Fig 1** to adjust the restrictor.
- 3 Tighten the back nut.
- 4 Connect the water supply.
- 5 Adjust water level with grey adjusting screw. See **Fig 2** for instructions on the water height.
- 6 Ensure connections are tight and secure.

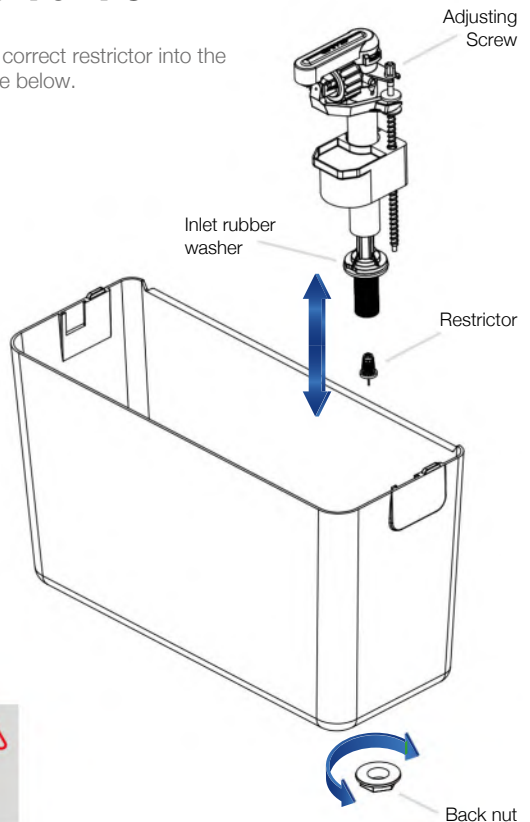

WARNING:

Do not over tighten.
Do not use any sealing paste or compound.



2. Instructions on how to install the Easyflush^{EVO} inlet valve

Fig 1

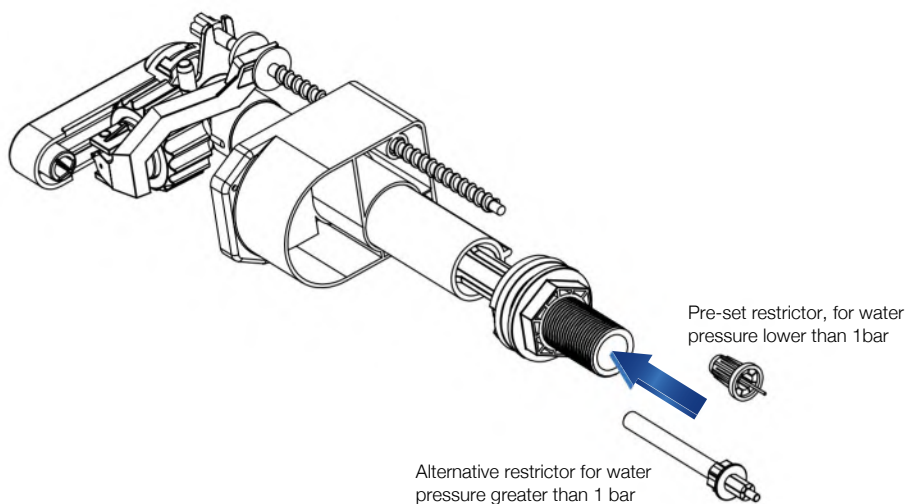
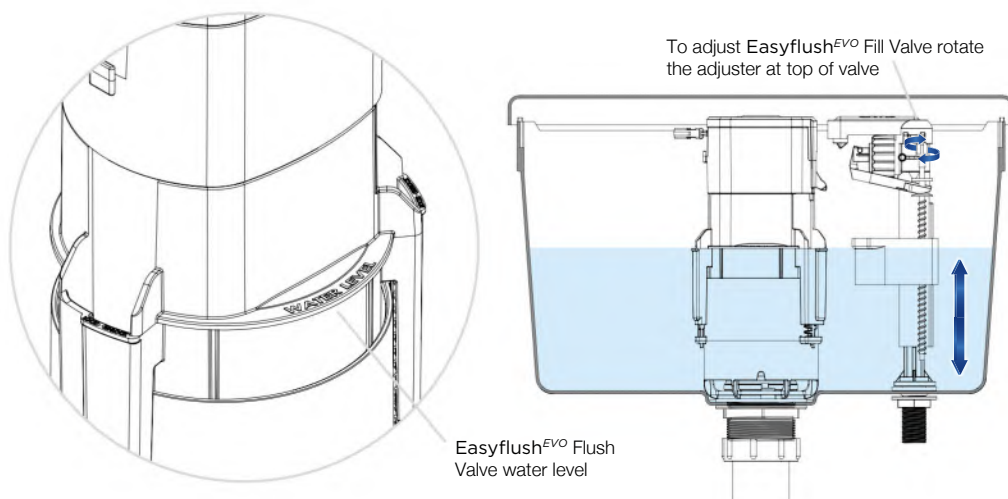

Fig 2

Ensure the fill valve is adjusted so the water shuts off at the indicated water level on the flush valve. This is your full flush volume.

The height of the Easyflush^{EVO} flush valve water level and the filling valve float level **must** be at the same height.



3. Maintenance

Fill valve (supplied with EVO CISTERN only): Periodically rinse the inlet filter and valve diaphragm. If the diaphragm is damaged contact Cisterniser for a replacement.

You may rinse the filter or the membrane to maintain your fill valve.

If the membrane is damaged, you need to replace it.

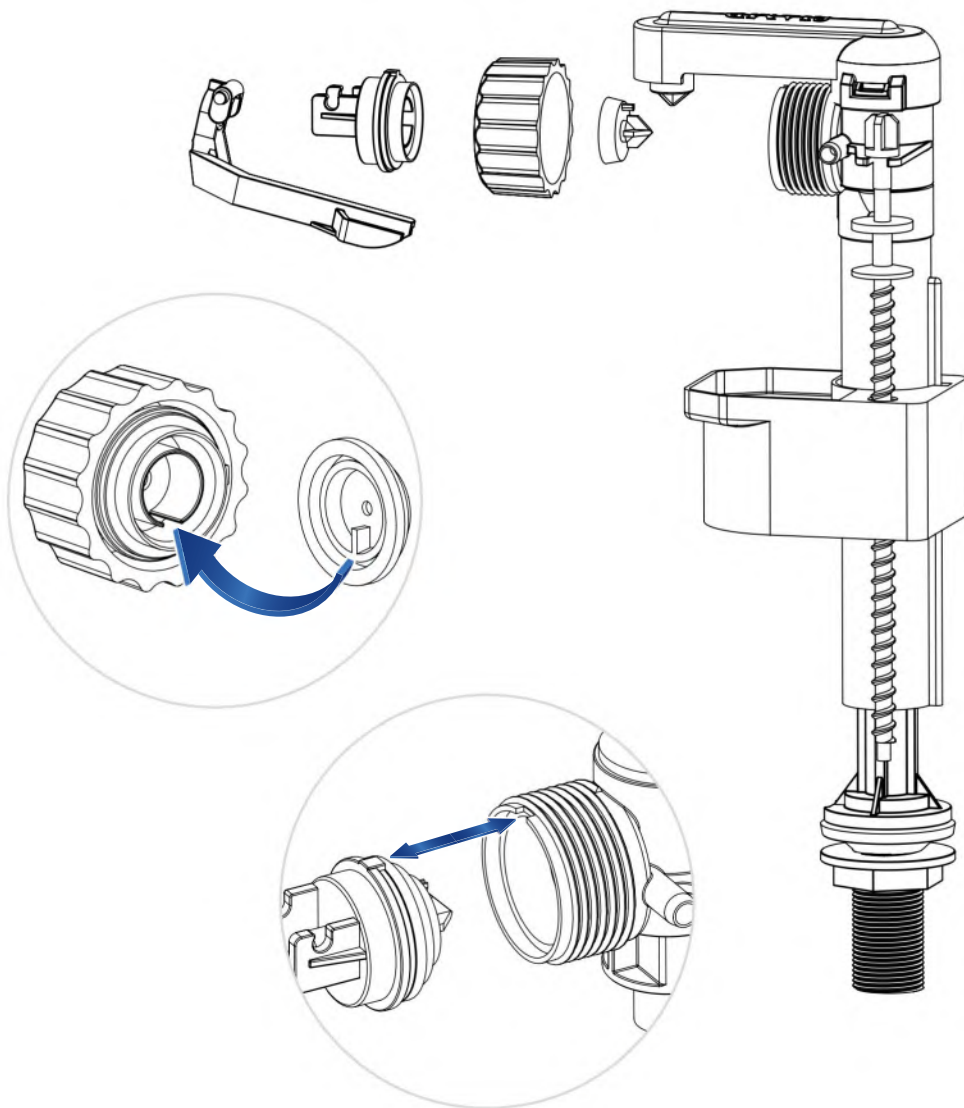

Cisterniser Limited

Unit 1, Woodley Park Estate, 59-69 Reading Road,
Woodley, Reading, Berkshire RG5 3AN

t: +44 (0) 118 969 1611

e: sales@cisterniser.co.uk

cisterniser.co.uk

Part of Genuit Group plc

